

# Doheny's Chlorinators - Item#: 2457, 2458, & 2459

## Parts Listing

#2458 AG Chlorinator

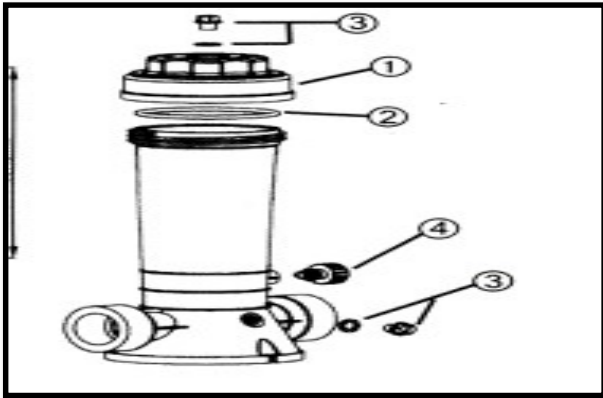

#2458 AG Chlorinator

Reference Number	Description	Number Required	Part Number
1	Cover	1	245712
2	O-Ring	1	<b>24572*</b>
3	Drain Plug w/ Gasket	2	<b>24571*</b>
4	Control Valve Assembly	1	<b>24574*</b>

#2457 IG Inline Chlorinator

Reference Number	Description	Number Required	Part Number
1	Cover	1	<b>245711*</b>
2	O-Ring	1	<b>24573*</b>
3	Drain Plug w/ Gasket	2	<b>24571*</b>
4	Control Valve Assembly	1	<b>24574*</b>

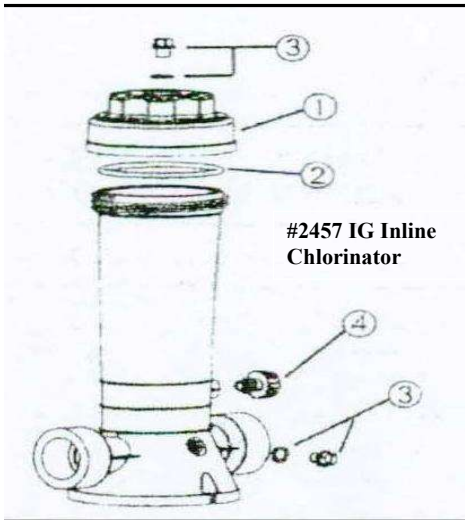

#2457 IG Inline Chlorinator

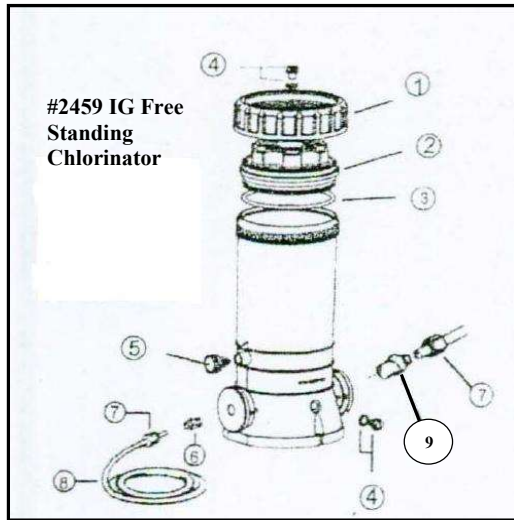

#2459 IG Free Standing Chlorinator

#2459 IG Free Standing Chlorinator

Reference Number	Description	Number Required	Part Number
1	Cover Cap	1	647016803080
2	Cover	1	<b>245711*</b>
3	O-Ring	1	<b>24573*</b>
4	Drain Plug w/ Gasket	2	<b>24571*</b>
5	Control Valve Assembly	1	<b>24574*</b>
6	Inlet Fitting Adapter	2	<b>24578*</b>
7	Compression Nuts	2	<b>24575*</b>
8	Plastic Tubing - 8ft	1	<b>24576*</b>
9	Check Valve Assembly	1	<b>24579*</b>
10 (not pictured)	Saddle Fitting	1	<b>24577*</b>
11 (not pictured)	Saddle Clamp	1	<b>245710*</b>

**Part Number Legend:**

**Bold\*** = Parts that are sold

*Italics* = Parts **NOT** sold but **MAY** be sent to customers w/ missing, defective or damaged parts upon arrival

Plain Font = Parts not sold or available (check warehouse to see if its available -if damaged, defective or missing)